



**MODERN BUILDING SYSTEMS, INC.**

*"The Environmentally Smart Choice..."*

# Project Summary

## Molecular Probes

www.mbs-modular.com



**Molecular Probes Inc.** is located in the west side of Eugene, Oregon. This particular 26,000 sf project was built in 1992 and features 2-story construction with a complete uninterruptible power supply system and an elevator.

A 50-foot skybridge was constructed to allow access to the second story offices from visitor parking situated on higher ground than the first floor. Lap siding and offices with a view are only a few of the visible advantages to this office.

Choosing modular construction allowed **Molecular Probes**, the option of leaving space in their design plans for future expansion. Interior finishes are drop grid ceilings, carpeted and vinyl floor coverings. Other visible advantages and features include interior finishes of taped, textured and painted sheet rock, reception area, private office space, meeting and lunch room, lab areas, refrigeration units for specimens and a sprinkler system for fire protection.

Modular construction was chosen by the fast growing, sophisticated bio-med technical company because of the speed that **Modern Building Systems** could deliver a completed project. Larger amounts of rain that spring impacted site scheduling but did not slow the projected opening date for the company's new headquarters.

The building's complete turnaround time from planning to completion was seven months. Modern Building Systems buildings are ideal for all types of building needs. Modular buildings are designed to provide tomorrow's solutions today.

### Features:

- Complete site development including excavation, utilities and parking lot
- Elevator system
- 50' skybridge to access 2nd floor, including concrete floors
- Advanced complete building uninterruptible power supply system
- Simultaneous site development and building construction
- Complete turnkey project

P.O. Box 110 9493 Porter Road  
Aumsville, OR 97325 USA  
tel: 503.749.4949  
fax: 503.749.4950

1550 Thornton Avenue SW  
Pacific, WA 98047 USA  
tel: 253.863.8863  
fax: 253.863.8867



**MODERN BUILDING SYSTEMS, INC.**

*"The Environmentally Smart Choice..."*

**Molecular Probes Inc**

**Molecular Probes Inc  
Biotechnology Office**

- 1. Offices
- 2. Reception Area
- 3. Lunch & Training Room
- 4. Conference Room
- 5. Lobby
- 6. Elevator
- 7. Customer Service
- 8. Restroom
- 9. Other

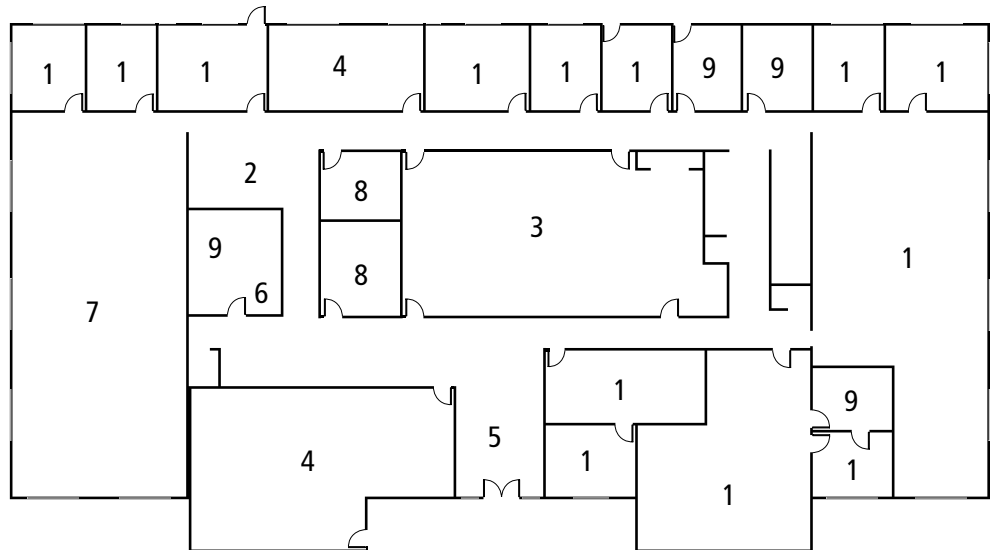

**Modern Building Systems, Inc.** Mobile and Modular Offices: Tomorrow's Solutions Today

When you consider the time, cost and flexibility your new building will involve—consider **Modern Building Systems**.

We offer speed and efficiency for expansion or relocation and can build to compliment existing structures. Our economical, attractive, and functional commercial space is built with environmentally responsible turnkey construction.

Complete services include design and engineering offering potential savings in construction costs over site-built buildings. Your complete facility will be built on our premises and is ready for immediate occupancy on your land within days. If you need, the entire modular building can be relocated to another site in the future.

Our personal service and professional staff will work with you to meet all your building needs. For an accurate advance estimate of the budget and time requirements of a modular solution, call today for more information.

"Modular buildings are fantastic. As soon as I can I'm going to build another. I can't understand why more people aren't building modular."

Jim Aydelott, Symantec Corporation, Operations Manager  
Seattle Daily Journal of Commerce

**Modern Building Systems, Inc.**

**800.682.1422**

Visit us at:

**[www.mbs-modular.com](http://www.mbs-modular.com)**

P.O. Box 110 9493 Porter Road

Aumsville, OR 97325 USA

tel: 503.749.4949

fax: 503.749.4950

**Washington**

1550 Thornton Avenue SW

Pacific, WA 98047 USA

tel: 253.863.8863

fax: 253.863.8867

**[www.mbs-modular.com](http://www.mbs-modular.com)**