



MODERN BUILDING SYSTEMS, INC.

"The Environmentally Smart Choice..."

Project Summary

Fort Stevens

www.mbs-modular.com



Fort Stevens is a public restroom/shower facility that was constructed for the State of Oregon Parks & Recreation Department. **Fort Stevens** is located outside Astoria, on the Northern Oregon Coast.

Site constraints into the park made modular construction the perfect solution for this state protected site. Modulares were shipped complete with cement floors and all fixtures installed at the manufacturing facility.

Completing as much work as possible at the manufacturing plant eliminated multiple vehicles and crews at the campground. Site utilities were installed while the building was being constructed as the manufacturing plant to minimize the overall time at the site.

Stainless steel items were installed throughout the building to eliminate rust in this salty coastal environment.

Keeping power consumption to a minimum was facilitated by installing occupancy sensors and sensor controls for lighting and fans. High efficiency gas boilers for hot water heaters and re-circulation system with expansion tanks were used on all water piping.

To aid in the longevity of the building, vandal proof fixtures were installed throughout the building from shower fixtures to toilet partitions.

Tongue & groove 2 x 6 exposed interior roof decking, cement fibre board & batt siding with brick wainscoting and standing seam metal roofing are just a few of the finishes used on this building.

Features:

- Pre-formed/poured cement floor
- Complete building shipped to minimize site damage
- Rust resistant finishes
- Concurrent construction
- Sturdy finishes for durability
- Vandal proof fixtures

P.O. Box 110 9493 Porter Road
Aumsville, OR 97325 USA
tel: 503.749.4949
fax: 503.749.4950

1550 Thornton Avenue SW
Pacific, WA 98047 USA
tel: 253.863.8863
fax: 253.863.8867



MODERN BUILDING SYSTEMS, INC.

"The Environmentally Smart Choice..."

Fort Stevens

**Fort Stevens
Public Restroom/Shower Facility**

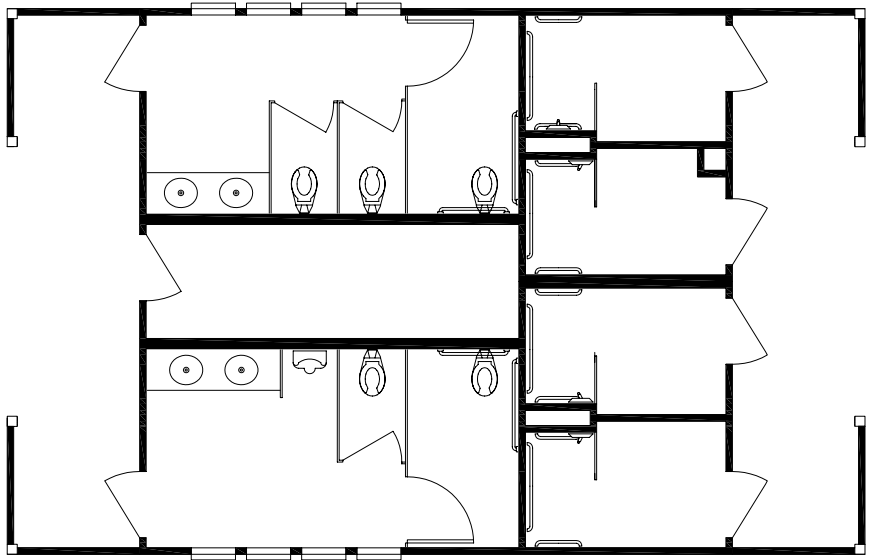

www.mbs-modular.com

Modern Building Systems, Inc. Mobile and Modular Offices: Tomorrow's Solutions Today

When you consider the time, cost and flexibility your new building will involve—consider **Modern Building Systems**.

We offer speed and efficiency for expansion or relocation and can build to compliment existing structures. Our economical, attractive, and functional commercial space is built with environmentally responsible turnkey construction.

Complete services include design and engineering offering potential savings in construction costs over site-built buildings. Your complete facility will be built on our premises and is ready for immediate occupancy on your land within days. If you need, the entire modular building can be relocated to another site in the future.

Our personal service and professional staff will work with you to meet all your building needs. For an accurate advance estimate of the budget and time requirements of a modular solution, call today for more information.

"Modular buildings are fantastic. As soon as I can I'm going to build another. I can't understand why more people aren't building modular."

Jim Aydelott, Symantec Corporation, Operations Manager
Seattle Daily Journal of Commerce

Modern Building Systems, Inc.

800.682.1422

Visit us at:

www.mbs-modular.com

P.O. Box 110 9493 Porter Road

Aumsville, OR 97325 USA

tel: 503.749.4949

fax: 503.749.4950

Washington

1550 Thornton Avenue SW

Pacific, WA 98047 USA

tel: 253.863.8863

fax: 253.863.8867